

I. Brief introduction

NB-T series wireless sensor, using the world's leading NB-IoT wireless communication module and dual sensor mode, the use of narrowband cellular communication technology (NB-IoT technique), with professional hardware and software design, so that the product has the advantages of powerful, small size, easy implementation, free wiring, reliable work, easy maintenance and so on. With remote prepaid, timing reporting temperature and humidity data.

II. Characteristics

- Strong anti-interference ability;
- Stable communication: through the base station, the signal is reliable and safe;
- Free cloud platform;
- Simple operation: no wiring, automatic connection upload;
- Support battery power;
- Periodic active reporting, configurable reporting collection period;
- Wechat scanning code, mobile phone real-time monitoring, view data;

III. Technical parameters

Power voltage: Battery powered

(2# Lithium ion battery 3.6V)

Output signal: NB-IOT

Transmission power: 23dbm

Sensitivity: -135db

Antenna gain: 3db

Antenna: Built-in

Data transfer mode: Proactively reporting

Measuring range:

Environmental temperature: -20°C ~ 60°C

Environmental humidity: 0% RH ~ 100% RH

Accuracy:

Environmental temperature: $\pm 0.5^\circ\text{C}$ (25°C)

Environmental humidity: $\pm 3\%$ RH

(5% RH ~ 95% RH, 25°C)

Long-term stability:

Environmental temperature: $\leq 0.5^\circ\text{C}/\text{y}$

Environmental humidity: $\leq 1\%$ RH/y

Resolution: 0.1°C; 0.1% RH

Startup time: ≤ 1 min

Sleep time: Setting range 5min ~ 24h (Default 30min)

Work environment: -20°C ~ 60°C; 5% RH ~ 95% RH

(Non condensation)

Storage conditions: -20°C ~ 60°C; 5% RH ~ 95% RH

(Non condensation)

Power loss: Maximum $\leq 0.9\text{W}$

Sleep $\leq 54\mu\text{W}$

Response time: < 30s (1m/s Wind speed)

Battery life: 1 year (1 time / 30min, 25°C $\pm 5^\circ\text{C}$, quantity of electricity 8.5Ah)

Installation: All in one

IV. External dimensions

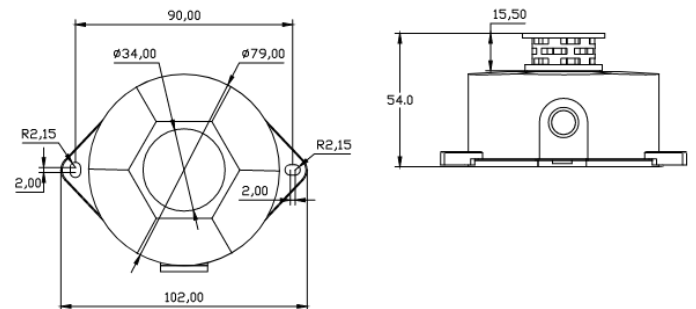

V. Installation

Installation steps:

When the transmitter is placed on the back of the plane or wall mount type: there are two $\phi 4$ installation holes on both sides of the transmitter, and the standard expansion screws and screws are used to fix the wall, and the expansion screws are used;

The installation looks like this:

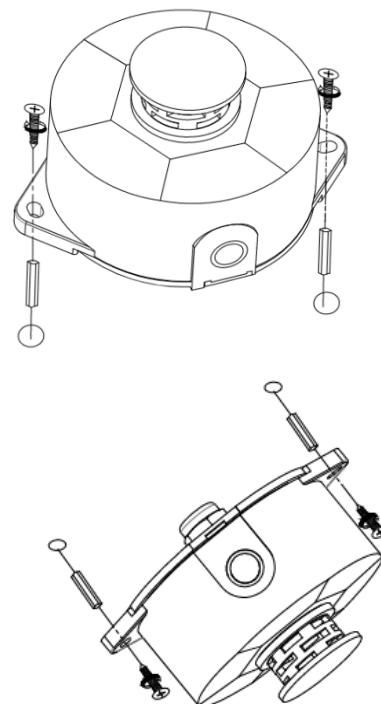

Installation location:

1. The transmitter should be placed horizontally, vertically and on top as far as possible, and when installed, ensure that the sensor is above the transmitter.
2. The installation height is the sitting height of the human body or the environmental area where the main requirements are measured.

Installation note:

1. Avoid the heat transfer and the installation of the temperature difference in the area where the temperature difference is caused by the easy heat transfer, otherwise the temperature and humidity measurement is not accurate.
2. Install in a relatively stable environment, avoid direct light, avoid Windows, air conditioning, heating, etc., avoid straight window and door.
3. Try to stay away from the high-power interference equipment, so as not to make the measurement impossible, such as a converter, an motor, etc.

VI. Use

1. Open the back cover, and the power supply of the device (the 2-bit dial-code switch is dial-ed to "ON") is shown in the red dial-code in Figure 1. Scan the code with the mini program in wechat to view the data;

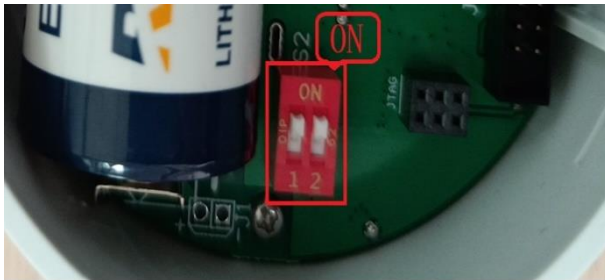

Figure 1

2. When the product is working normally: the program enters the process of collection -- operation -- transmission -- sleep;
3. The transmitter is an indoor type, and water is not allowed to enter the transmitter to avoid damage.

VII. Attention

1. Please read this manual carefully before use, avoid easy heat transfer and will directly prevent chemical reagents, oil, dust and other direct damage to the sensor, do not use in dew, extreme temperature environment for a long time. No cold or heat shock.
2. This product is an electronic product, and it will cause environmental pollution when scrapped. It

should follow the relevant standards of national electronic devices when scrapped.

VIII. Transportation, storage

1. Transmitter try to avoid vibration, lightly take and put.
2. Long-term optimal storage conditions: 10°C ~ 40°C; 20% RH ~ 50% RH.

IX. Open box inspection

1. After opening the package, check whether the transmitter is intact.
2. Transmitter 1set
Manual 1serving
Certificate of conformity 1sheet
Magnet steel 1set

X. Network access process

1. Open wechat and click search "process cloud", as shown in Figure.



Click the applet to appear:



2. Click Register, you can apply for your own account with your mobile phone number. If you use it temporarily, you can choose to use the demo account to enter. Select device DIY under the application menu, click Enter, and click the scan code at the bottom of the screen to add devices.



3. After clicking, scan the QR code on the "Product label" and the picture below the pop-up window



Fill in the device name and click "OK" to add the device to the app.

4. After the device runs and reports the data, the data can be viewed on this interface

